

Mini Scorpio EZ

USER MANUAL





SERVICEVISION BIS SL

Ríos Rosas, 20 · 08940 CORNELLA DE LLOBREGAT (Barcelona) Spain · Tel. 34 93 223 86 30 · Fax 34 93 223 86 31
comercial@servicevision.es · www.servicevision.es

1-: Technical specifications:

Weight:	13,5kg (29,7lbs)
Max. Payload:	45kg (99,2lbs)
Rotation for Pan & Tilt:	360° (limited turns)
Power output for camera:	Yes, 12v/10A
Video output:	No, direct from camera
Power requirements:	24v to 35v (power supply or battery)
Max. speed:	2,5sec per turn.

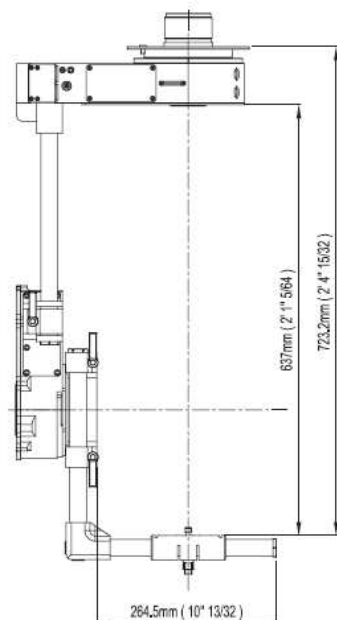
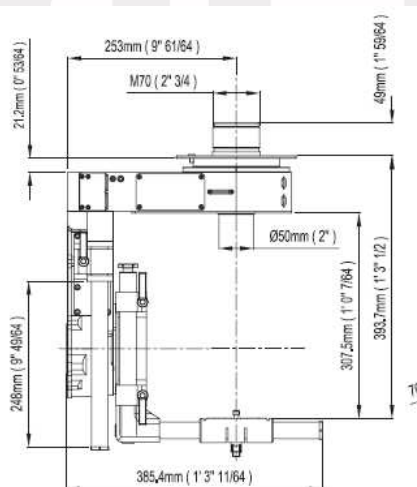
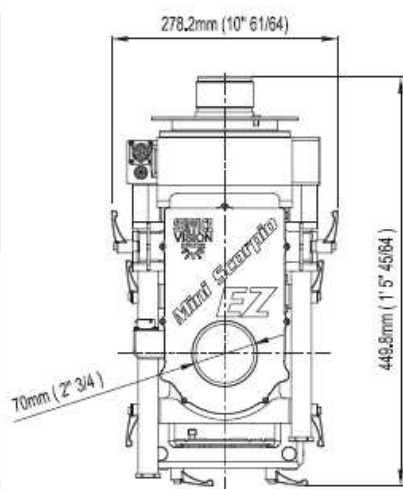

SERVICEVISION BIS SL

Ríos Rosas, 20 · 08940 CORNELLA DE LLOBREGAT (Barcelona) Spain · Tel. 34 93 223 86 30 · Fax 34 93 223 86 31
comercial@servicevision.es · www.servicevision.es

2: Parts and components

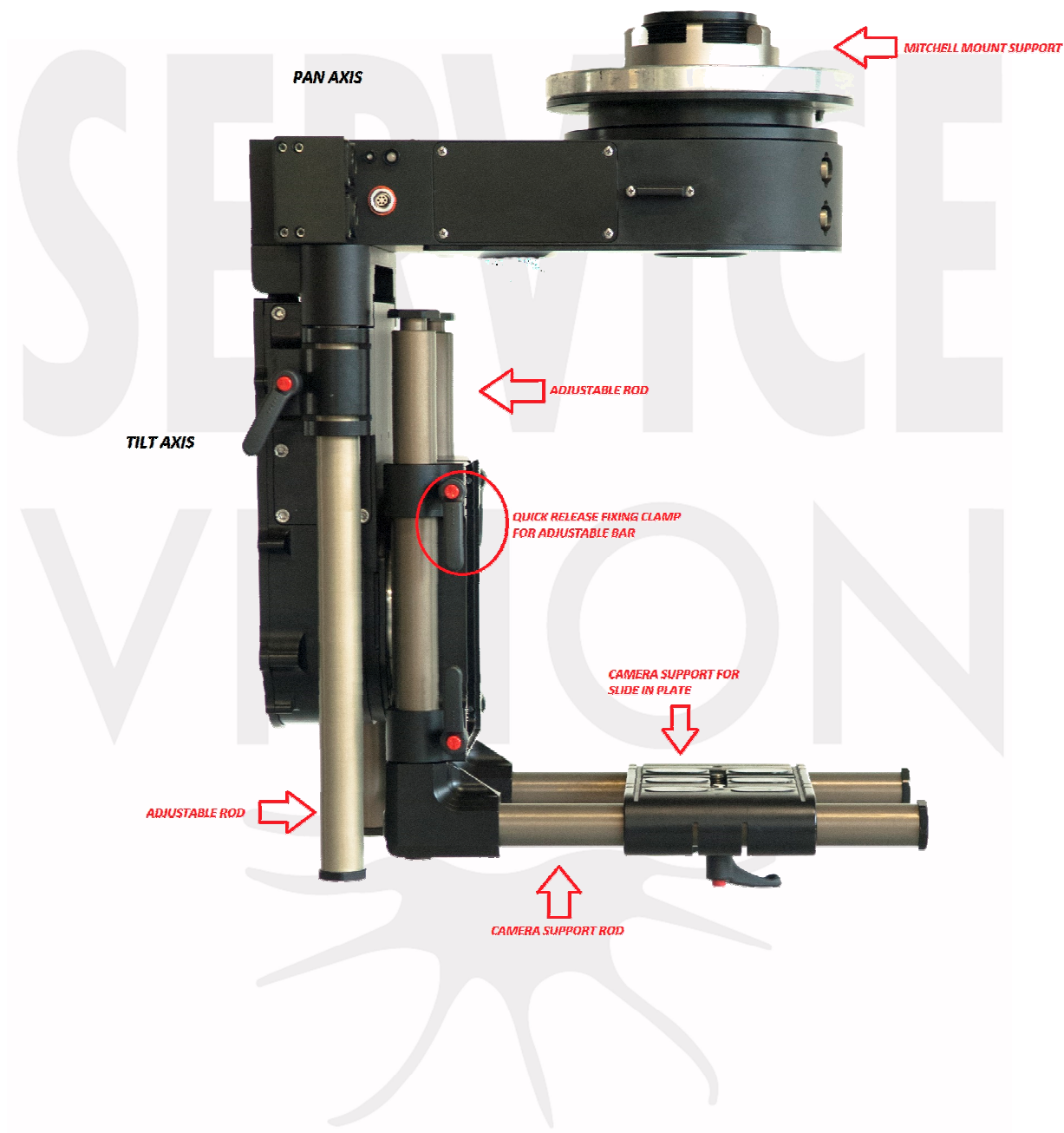

SERVICEVISION BIS SL

Ríos Rosas, 20 · 08940 CORNELLA DE LLOBREGAT (Barcelona) Spain · Tel. 34 93 223 86 30 · Fax 34 93 223 86 31
comercial@servicevision.es · www.servicevision.es

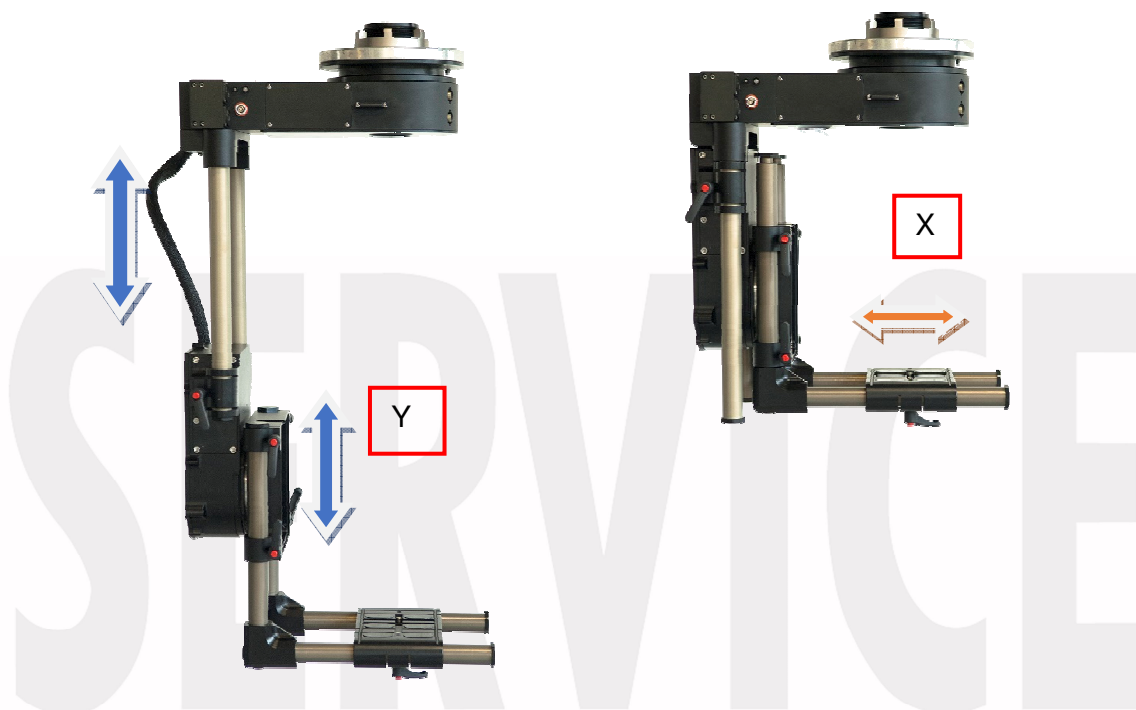

Adjustable rods allow you a very quick head configuration (compact or large) as well as a very quick camera balance by using the camera support base.

To balance the camera always start with the Y axis. Position the camera in central (vertical) position, move the adjustable rods for balance. Then the X axis, position the camera in perpendicular position (90° to the floor) and slide the camera support plate front or backwards for balance.



SERVICEVISION BIS SL

Ríos Rosas, 20 · 08940 CORNELLA DE LLOBREGAT (Barcelona) Spain · Tel. 34 93 223 86 30 · Fax 34 93 223 86 31
comercial@servicevision.es · www.servicevision.es

Pan axis:

It houses the intelligent board (Servo I board to control Pan and Tilt and one Driver board for the Pan motor).

Two LED light will indicate the status for these boards D for the DRIVER board status and S for the SERVO board status.

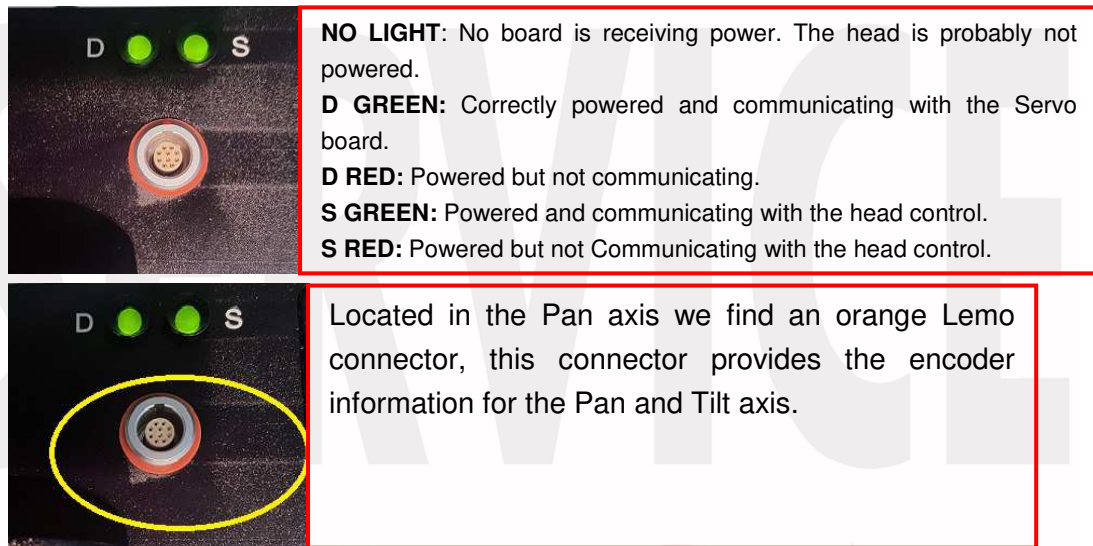

Power and communication



HEAD COMMAND: Standard Scorpio communication. (NEUTRIK, 6 pin male, panel mount, NC6MDL1-B)

TILT: Head inter-axis communication and power from Pan axis to tilt axis.

VDC IN 24/30V HEAD: Standard Scorpio power. (NEUTRIK, 3 pin male, panel mount, NC3MDL1-B)

VDC IN 24/30V CAMERA: Standard Scorpio power. (NEUTRIK, 3 pin male, panel mount, NC3MDL1-B).

Tilt axis:

It houses the Driver board for the motor of the tilt axis, this board is controlled by the Servo board located in the Pan Axis.



It also has an LED light to indicate the status of the Driver board (same color code than in Pan axis). The red Lemo connector (LEMO, 5 pin female, panel mount, EGG.1B.305) is for the Scorpio FIZ control, it powers the box and communicate with the system, for both Scorpio Servolens Control and the Scorpio Motor Driver Box.

Camera power (12V/10A) (BURNDY, 4 pin female, panel mount, UT00104ST). The green LED light will indicate that 12V output is correctly working.



PINOUT:

Head command: (NEUTRIK, 6 pin male, panel mount, NC6MDL1-B)

- 1 NC
- 2 NC
- 3 GND
- 4 VCC OUT+30V
- 5 485B-
- 6 485A-

VDC Head: (NEUTRIK, 3 pin male, panel mount, NC3MDL1-B)

- A1 VCC IN 24-35V
- A2 GND
- A3 NC

VDC Camera: (NEUTRIK, 3 pin male, panel mount, NC3MDL1-B)

- A1 VCC IN 24-35V
- A2 GND
- A3 NC

FIZ power: (LEMO, 5 pin female, panel mount, EGG.1B.305)

- 1 VCC OUT 30V
- 2 GND
- 3 485A Gray
- 4 485B Red
- 5 NC

Camera power: (BURNDY, 4 pin female, panel mount, UT00104ST)

- A VCC OUT 12V
- B GND
- C NC
- D GND

Enforcing cage

Optional accessory for big camera packages up to 45kgs (99,2lbs).

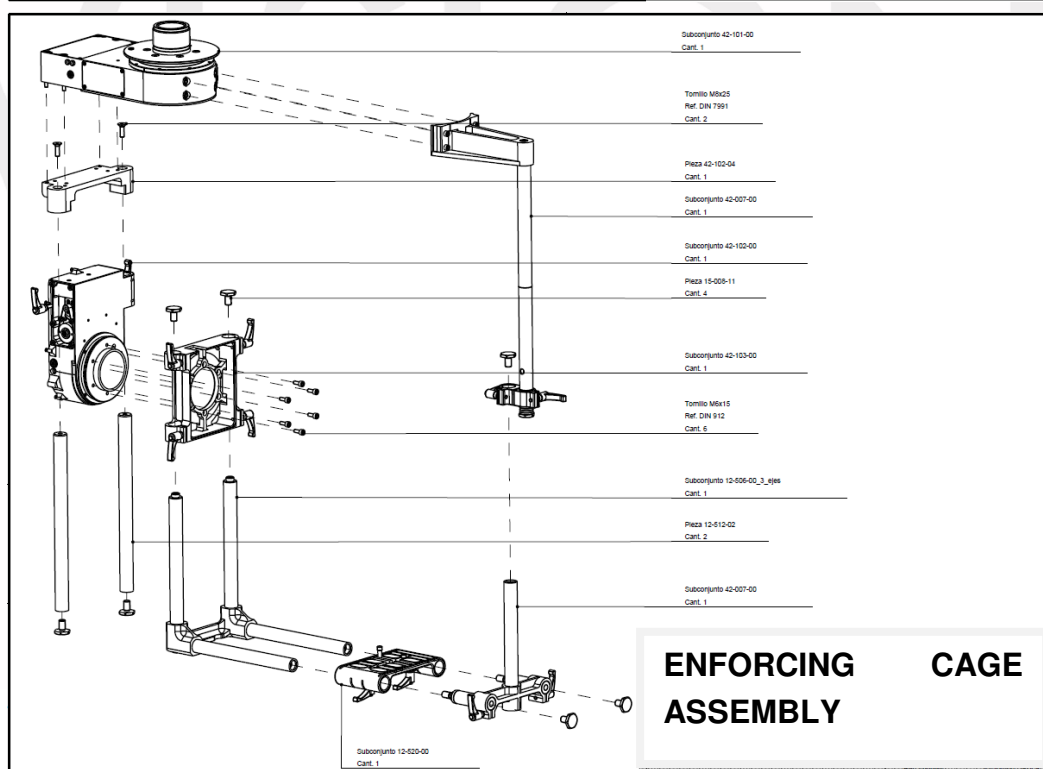
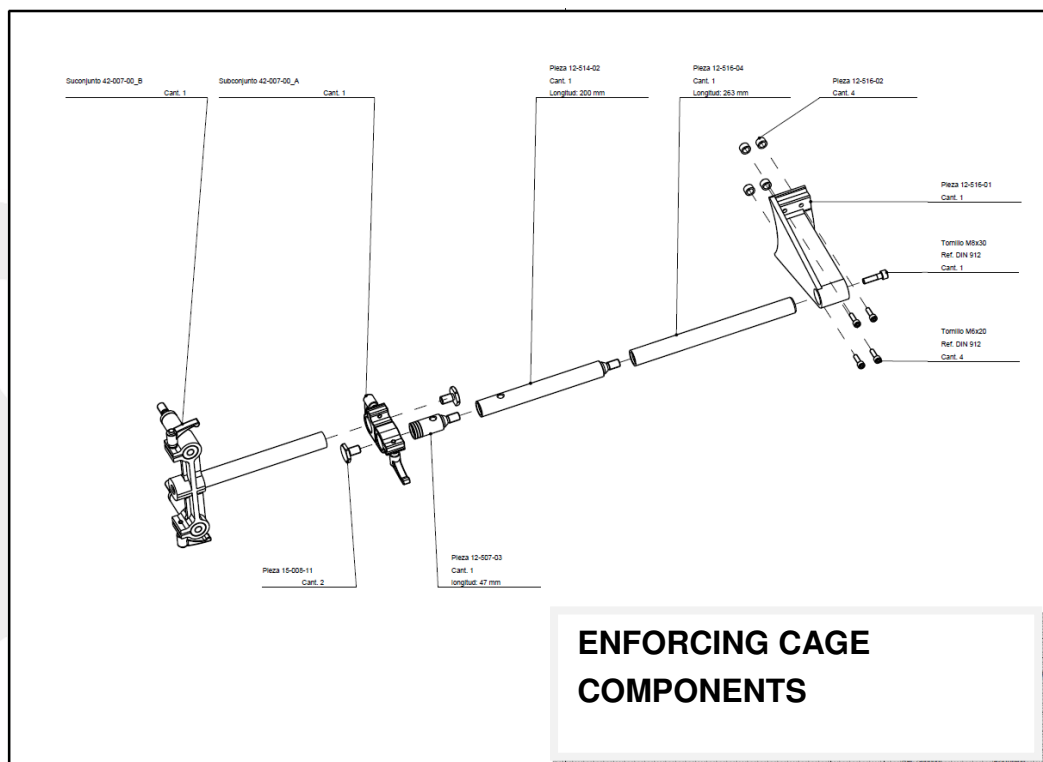

SERVICEVISION BIS SL

Ríos Rosas, 20 · 08940 CORNELLA DE LLOBREGAT (Barcelona) Spain · Tel. 34 93 223 86 30 · Fax 34 93 223 86 31

comercial@servicevision.es · www.servicevision.es